

Specialty Tools

- Double Edge
- Solid Carbide
- Foam Cutters

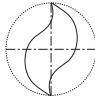

For Use On:
Foam

Foam cutters for thick material with upward chip flow.

Catalog Number	Cutting Edge Dia.	Cutting Edge Length	Shank Dia.	Overall Length
H25XOS-52-554	1/8	1-1/8	1/4	2-1/2
H25XOS-52-558	3/16	1-5/8	3/16	
H25XOS-52-560				3
H25XOS-52-564	1/4	2-1/4	1/4	4
H25XOS-52-570	5/16	3-1/8	5/16	4-1/2
H25XOS-52-574	3/8	3-1/2	3/8	5

Helix Angle ≈25°

- Four Edge
- High-Speed Steel
- Upcut Spiral Foam Cutters



For Use On:
Foam

Designed to cut thick foam with upward chip flow.

Catalog Number	Cutting Edge Dia.	Cutting Edge Length	Shank Dia.	Overall Length
H25XOS-40-562	1/2	3-5/8	1/2	6
H25XOS-40-564		4-1/8		6-1/2

Helix Angle ≈25°

Specialty Tools

■ Solid Carbide Edge Rounding

For Use On:

Soft Plastic: ABS, Polycarbonate, Polyethylene, PVC, Polypropylene, HDPE, Polystyrene, UHMW, and Extruded Acrylic

Hard Plastic: Cast Acrylic, Melamine, Nylon, PVC and Vinyl

Solid Surface

Designed for rounding the edge of sheets or parts. They come in both single edge and double edge.

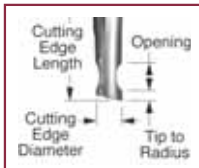

Single Edge
Straight O Flute



Single Edge
Spiral O Flute



Double Edge
Straight O Flute

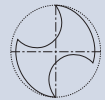
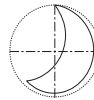

SINGLE EDGE

Catalog Number	Cutting Edge Dia.	Cutting Edge Length	Shank Dia.	Overall Length	Opening	Radius	SM Cutting Edge Dia.	Tip to Radius	Plastic Size
Straight O Flute									
H25XOS-66-082	1/4	3/8	1/4	2-1/2	5/32	1/8	.195	1/16	1/8
H25XOS-66-083					7/32	3/16	.180		3/16
H25XOS-66-084					9/32	1/4	.163		1/4
Spiral O Flute									
H25XOS-66-085	1/4	3/8	1/4	2-1/2	5/32	1/8	.195	1/16	1/8
H25XOS-66-086					7/32	3/16	.180		3/16
H25XOS-66-087					9/32	1/4	.163		1/4

Helix Angle $\approx 22^\circ$

DOUBLE EDGE STRAIGHT O FLUTE

Catalog Number	Cutting Edge Dia.	Cutting Edge Length	Shank Dia.	Overall Length	Opening	Radius	SM Cutting Edge Dia.	Tip to Radius	Plastic Size
Inch									
H25XOS-66-092	1/4	3/8	1/4	2-1/2	5/32	1/8	.195	1/16	1/8
H25XOS-66-093					7/32	3/16	.180		3/16
H25XOS-66-094					9/32	1/4	.163		1/4
Metric									
mm									
H25XOS-66-073	6	10	6	64	4	3	4.47	1.5	3
H25XOS-66-074					5	4	4.24		4
H25XOS-66-075					6	5	3.96		5
H25XOS-66-076					7	6	3.73		6

Specialty Tools

■ Solid Carbide Edge Rounding

For Use On:

Soft Plastic: ABS, Polycarbonate, Polyethylene, PVC, Polypropylene, HDPE, Polystyrene, UHMW, and Extruded Acrylic

Hard Plastic: Cast Acrylic, Melamine, Nylon, PVC and Vinyl

Solid Surface

Designed for rounding the edge of sheets or parts. They come in both single edge and double edge.

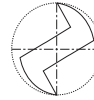

DOUBLE EDGE STRAIGHT V FLUTE

Catalog Number	Cutting Edge Dia.	Cutting Edge Length	Shank Dia.	Overall Length	Opening	Radius	SM Cutting Edge Dia.	Tip to Radius	Plastic Size
Inch									
H25XOS-66-120	3/8	3/8	3/8	2-1/2	5/32	1/8	.320	1/16	1/8
H25XOS-66-121					3/8	3/16	.305		3/16
H25XOS-66-122		1/2			1/4	.288	1/4		
H25XOS-66-123	1/2	3/8	1/2	3	13/32	3/8	.255		3/8
H25XOS-66-160					5/32	1/8	.445		1/8
H25XOS-66-161		3/8			3/16	.430	3/16		
H25XOS-66-162		5/8			1/4	.413	1/4		
H25XOS-66-163					17/32	1/2	.347	1/2	
Metric									
	mm								
H25XOS-66-077	8	12	8	64	9	8	5.21	1.5	8
H25XOS-66-078	10	14	10	70	11	10	6.68		10
H25XOS-66-079	12	16	12	76	13	12	8.18		12

Specialty Tools

- Double Edge
- Solid Carbide
- Rout & Chamfer

For Use On:

Soft Plastic: ABS, Polycarbonate, Polyethylene, PVC, Polypropylene, HDPE, Polystyrene, UHMW, and Extruded Acrylic

Hard Plastic: Cast Acrylic, Melamine, Nylon, PVC and Vinyl

Designed to provide up to a 1/16 top face chamfer and a finished side edge on plastic sheets or parts.

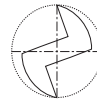

Catalog Number	Cutting Edge Diameter	Cutting Edge Length	Shank Diameter	Overall Length	Material Thickness
H25XOS-66-200	1/4	3/16	3/8	2-1/4	1/8
H25XOS-66-202	3/8		1/2	3	
H25XOS-66-204	1/4	1/4	3/8	2-1/4	3/16
H25XOS-66-206	3/8		1/2	3	
H25XOS-66-208	1/4	5/16	3/8	2-1/4	1/4
H25XOS-66-210	3/8		1/2	3	

Helix Angle $\approx 0^\circ$

Specialty Tools

- Double Edge
- Solid Carbide
- Upcut Bottom Surfacing

For Use On:

Soft Plastic: ABS, Polycarbonate, Polyethylene, PVC, Polypropylene, HDPE, Polystyrene, UHMW, and Extruded Acrylic

Hard Plastic: Cast Acrylic, Melamine, Nylon, PVC and Vinyl

Aluminum

Solid Surface

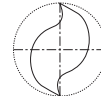

Designed for pocketing applications where the bottom of the pocket must be smooth.

Catalog Number	Cutting Edge Diameter	Corner Radius	Cutting Edge Length	Shank Diameter	Overall Length	
H25XOS-66-306	1/8	.020	1/4	1/8	2	
H25XOS-66-307		.002				
H25XOS-66-308		.020				
H25XOS-66-309		.002				
H25XOS-66-314	1/4	.030	3/8	1/4		
H25XOS-66-315		.002				
H25XOS-66-320	3/8	.030	5/8	3/8		2-1/2
H25XOS-66-321		.002				
H25XOS-66-326	1/2	.030	7/8	1/2	3	
H25XOS-66-327		.002				
H25XOS-66-328	3/4	.040	1-1/8	3/4		

Helix Angle ≈30°

Specialty Tools

■ Plastic Drills with Special Point

For Use On:

Soft Plastic: ABS, Polycarbonate, Polyethylene, PVC, Polypropylene, HDPE, Polystyrene, UHMW, and Extruded Acrylic

Hard Plastic: Cast Acrylic, Melamine, Nylon, PVC and Vinyl



Special tool steel, surface-treated body, flute and point for maximum lubrication. Point is precision ground at 60° angle for gradual penetration to minimize cracking and chipping of plastic materials. 0° rake angle on the cutting edge eliminates grabbing as the drill comes through the plastic surface.

Catalog Number	Cutting Edge Dia.	Cutting Edge Length	Shank Dia.	Overall Length
Fractional Drills				
H25XOS-70-502	1/8	1-1/2	1/8	2-3/4
H25XOS-70-503	9/64	1-3/4	9/64	2-7/8
H25XOS-70-506	5/32	1-15/16	5/32	3-1/8
H25XOS-70-509	11/64	1-3/4	11/64	3-1/4
H25XOS-70-510	3/16	2-1/8	3/16	3-1/2
H25XOS-70-511	13/64	2-7/16	13/64	3-5/8
H25XOS-70-512	7/32	2-1/2	7/32	3-3/4
H25XOS-70-513	15/64	2-5/8	15/64	3-7/8
H25XOS-70-514*	1/4	2-7/16	1/4	4
H25XOS-70-515	17/64	2-7/8	17/64	4-1/8
H25XOS-70-516	9/32	2-15/16	9/32	4-1/4
H25XOS-70-517	19/64	3-1/16	19/64	4-3/8
H25XOS-70-520*	5/16	1-3/4	5/16	3-1/8
H25XOS-70-521	21/64	3-5/16	21/64	4-5/8
H25XOS-70-522	11/32	3-7/16	11/32	4-3/4
H25XOS-70-523	23/64	3-1/2	23/64	4-7/8
H25XOS-70-524*	3/8	2-1/4	3/8	4-3/8
H25XOS-70-525	25/64	3-3/4	25/64	5-1/8
H25XOS-70-526	13/32	3-7/8	13/32	5-1/8
H25XOS-70-527	27/64	3-15/16	27/64	5-3/8
H25XOS-70-528*	7/16	2-1/2	7/16	4-3/4
H25XOS-70-529	29/64	4-3/16	29/64	5-5/8
H25XOS-70-530	15/32	4-5/16	15/32	5-3/4
H25XOS-70-531	31/64	4-3/8	31/64	5-7/8

*Shank length 7/8

Catalog Number	Cutting Edge Dia.	Cutting Edge Length	Shank Dia.	Overall Length
H25XOS-70-532*	1/2	2-5/8	1/2	5-1/8
H25XOS-70-533	33/64			
H25XOS-70-534	17/32			
H25XOS-70-535	35/64			
H25XOS-70-536	9/16	3-1/8	1/2	6
H25XOS-70-537	37/64			
H25XOS-70-538	19/32			
H25XOS-70-539	39/64			
H25XOS-70-540	5/8			
H25XOS-70-541	41/64			
H25XOS-70-542	21/32			
H25XOS-70-543	43/64			
H25XOS-70-544	11/16	3-1/8	1/2	6
H25XOS-70-545	45/64			
H25XOS-70-546	23/32			
H25XOS-70-547	47/64			
H25XOS-70-548	3/4			
H25XOS-70-549	49/64			
H25XOS-70-550	25/32			
H25XOS-70-551	51/64			
H25XOS-70-552	13/16			
H25XOS-70-553	53/64			
H25XOS-70-554	27/32	3-1/8	1/2	6
H25XOS-70-555	55/64			
H25XOS-70-556	7/8			
H25XOS-70-557	57/64			
H25XOS-70-558	29/32			
H25XOS-70-559	59/64			
H25XOS-70-560	15/16			
H25XOS-70-561	61/64			
H25XOS-70-562	31/32	3-1/8	1/2	6
H25XOS-70-563	63/64			

Specialty Tools

■ Engraving Tools

For Use On:

Softwood: Cedar, Cottonwood, Pine and Redwood

Hardwood: Ash, Beech, Birch, Cherry, Mahogany, Maple, Oak, Poplar, Teak and Walnut

Soft Plastic: ABS, Polycarbonate, Polyethylene, PVC, Polypropylene, HDPE, Polystyrene, UHMW, and Extruded Acrylic

Hard Plastic: Cast Acrylic, Melamine, Nylon, PVC and Vinyl

Aluminum

Solid Surface



The engraving tools are offered with a wide range of tip sizes and angles to accommodate many engraving styles.

Catalog Number	Cutting Edge Diameter	Overall Length	Shank Diameter	Cut Type	Suggested Use	
H25A00-18112005	0.005"	1-1/2	1/8	30° From Vertical	General Engraving	
H25A00-18112010	0.010"					
H25A00-18112020	0.020"					
H25A00-18112005B	0.005"			15° From Vertical		Engraving Brass/Aluminum
H25A00-18112010B	0.010"					
H25A00-18112005F	0.005"					
H25A00-18112010F	0.010"					
H25X00-ENGRAVE	14-Bit Solid Carbide Engraving Kit Includes 2-pieces of each bit in the table above.					



Available 14-Bit Solid Carbide Engraving Kit